



Shanghai Lunsure Electronic
Technology Co.,Ltd
Tel:0086-21-37185008
Fax:0086-21-57152769

KBU8A THRU KBU8M

Features

- Low Forward Voltage Drop
- Ideal For Printer Circuit Boards
- High Current Capability and High Reliability
- High Surge Current Capability

8 Amp Single Phase Bridge Rectifier 50 to 1000 Volts

Maximum Ratings

- Operating Temperature: -50°C to +150°C
- Storage Temperature: -50°C to +150°C

Catalog Number	Device Marking	Maximum Reccurent Peak Reverse Voltage	Maximum RMS Voltage	Maximum DC Blocking Voltage
KBU8A	KBU8A	50V	35V	50V
KBU8B	KBU8B	100V	70V	100V
KBU8D	KBU8D	200V	140V	200V
KBU8G	KBU8G	400V	280V	400V
KBU8J	KBU8J	600V	420V	600V
KBU8K	KBU8K	800V	560V	800V
KBU8M	KBU8M	1000V	700V	1000V

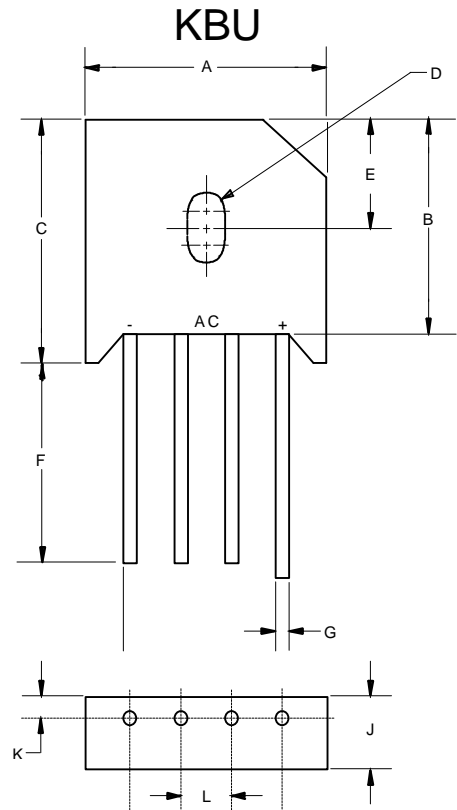

Electrical Characteristics @ 25°C Unless Otherwise Specified

Average Forward Current (NOTE 1,2)	$I_{F(AV)}$	8 A	$T_C = 100^\circ\text{C}$
Peak Forward Surge Current	I_{FSM}	200A	8.3ms, half sine
Maximum Instantaneous Forward Voltage	V_F	1.0V	$T_C = 25^\circ\text{C}$
Maximum DC Reverse Current At Rated DC Blocking Voltage	I_R	10 μA 300mA	$T_C = 25^\circ\text{C}$ $T_C = 100^\circ\text{C}$

DIM	INCHES		MM		NOTE
	MIN	MAX	MIN	MAX	
A	.895	.935	22.7	23.7	
B	.600	.700	16.8	17.8	
C	.740	.780	18.8	19.8	NOM
D	.15 \varnothing x	.23L	3.8 \varnothing x	5.7L	HOLE
E	---	.300	---	7.5	NOM
F	.100	--	25.4	---	
G	.048	.052	1.2	1.3	
J	.268	.280	6.8	7.1	
K	---	.140	---	5.3	NOM
L	.180	.220	4.6	5.6	3PL

*Pulse Test: Pulse Width 300 μsec , Duty Cycle 2%

Figure 1
Typical Forward Characteristics

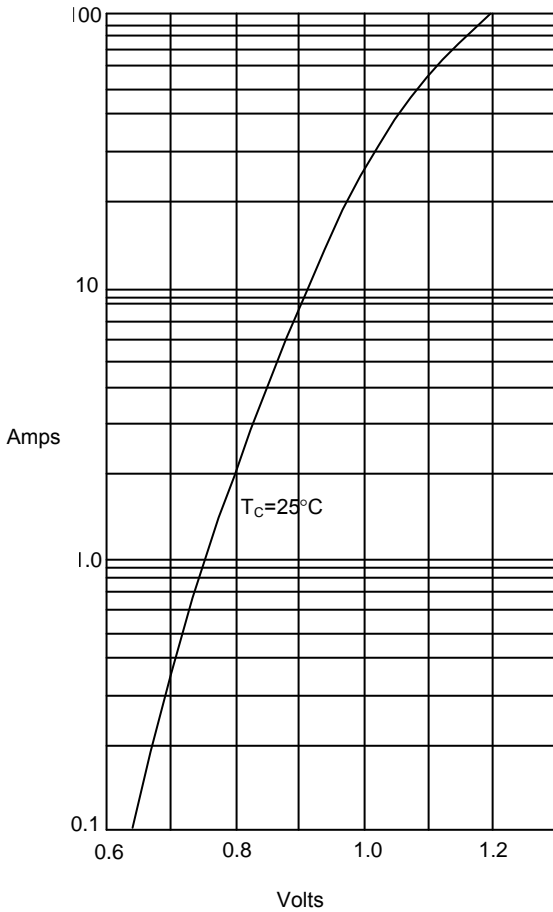

Instantaneous Forward Current - Amperes versus
Instantaneous Forward Voltage - Volts

Figure 2
Typical Reverse Characteristics

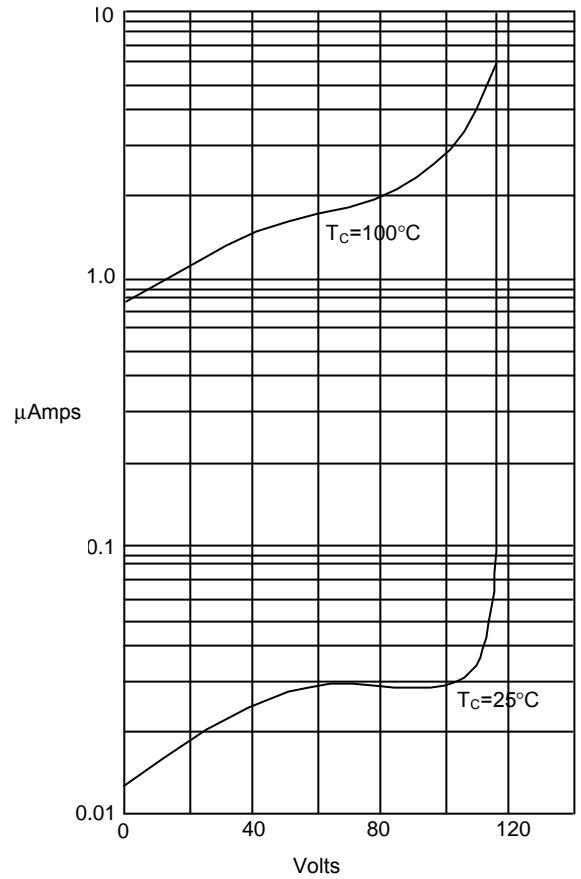

Instantaneous Reverse Leakage Current - MicroAmperes versus
Percent Of Rated Peak Reverse Voltage - Volts

Figure 3
Forward Derating Curve

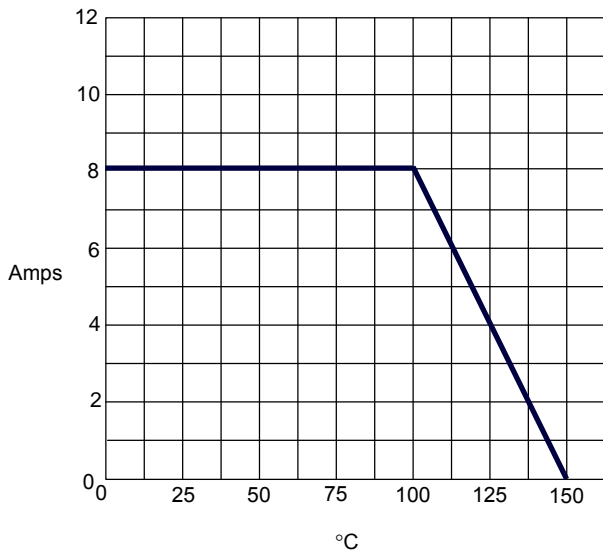

Average Forward Rectified Current - Amperes versus
Ambient Temperature - °C